

GEN. TOLERANCES	0.5 - 6	±0.1	6 - 30	±0.2	30 - 120	±0.3	120 - 315	±0.5	315 - 1000	±0.8	1000 - 2000	±1.2	2000 - 4000	±2	4000 - 8000	±3
GEN. MACHINING	0.4	1.6	3.2	6.3	12.6	25	50	100	200	400	800	1600	3200	6400	12800	25600

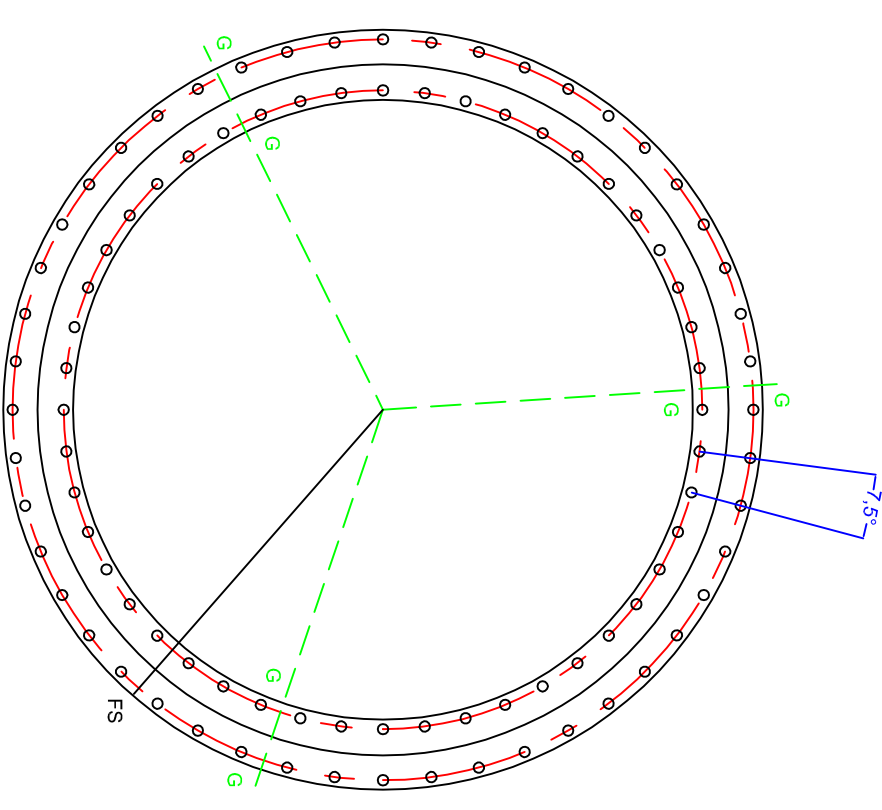
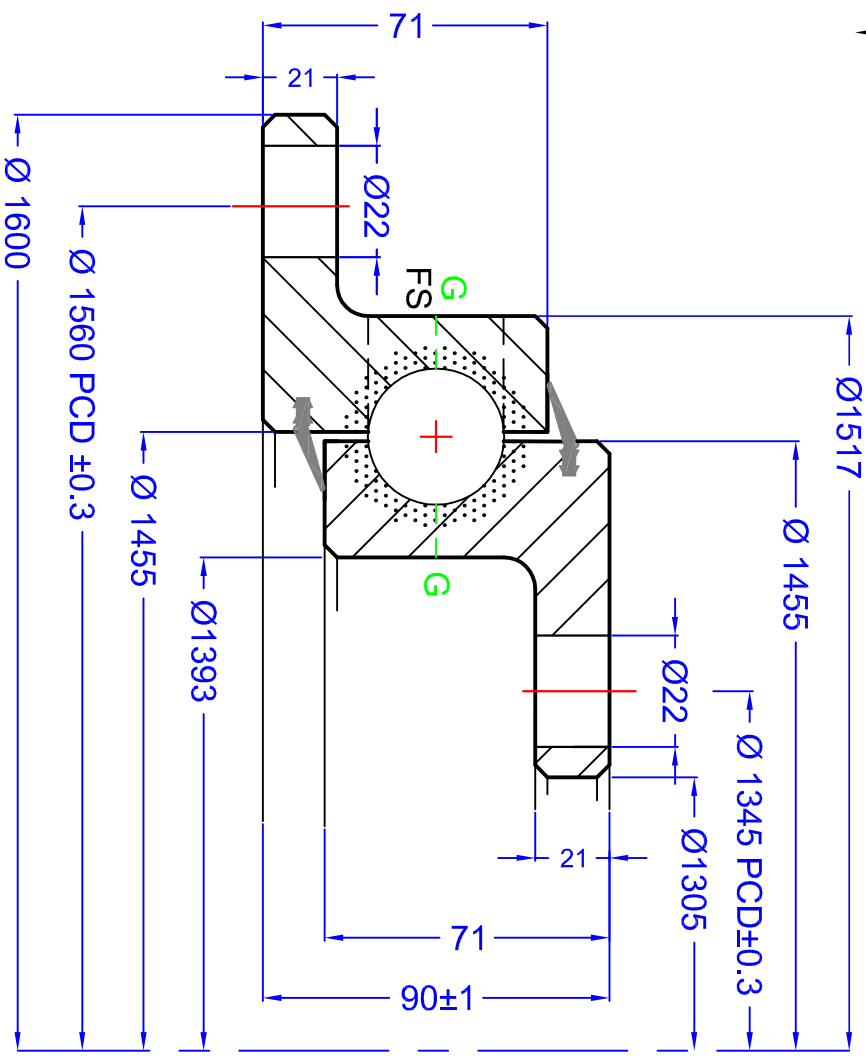
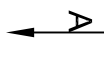

GEAR DATA

HARDED GEAR	MODULE (m)	Designed in accordance with designated QCB SLEWING RING STANDARDS													
NUMBER OF TEETH (z)	DP	Non toleranced dimensions to ISO 2768-1 m													
PRESSURE ANGLE (α)		All burrs and sharp edges to be removed. Standard corner chamfer 1mm x 45°													
ADDENDUM COEFFICIENT (α)		Internal radial and axial clearance figures to QCB standard 2014 or revisions thereof													
TRUNCATION (km)		The HAPINESS GAP is to be indicated by stamped letter R or a PAINT mark on the exterior surface													
PROFILE CORRECTION (km)		The high point of gear eccentricity to be indicated by GREEN or BLUE paint on 3 teeth													
CALCULATED GEAR STRENGTH															
INNER	48 =														
OUTER	48 =														
GREASE HOLES	G'														
LOADING PLUG	FS														
SOFT ZONE	IR														
SEAL SIZE	TBA														

BOLT DATA

INNER	Ø 22	MOUNTING HOLES	Ø 22	TURNING TORQUE	Nm
OUTER	Ø 22	MOUNTING HOLES	Ø 22	MATERIAL	42CrMo4 Q&T
GREASE HOLES	G'	2 X 3 M10	WEIGHT	200 kg (est)	
LOADING PLUG	FS	SOFT ZONE	IR	REF. OF STANDARD (optional)	
SEAL SIZE	TBA				

REV	DATE	MODIFICATION	REVISED BY
1			

QCB Bearings SLEWING RINGS & DRIVES

Orleton Lane, Wellington, Telford, TF1 2BG, UK
 P: 01962 222300 F: 01962 242938
 www.nbogroup.co.uk

QCB® is a registered trademark of NBC Group Ltd

FUN 1600 32 00 AA LM

DRAWN:	LW
DATE:	20/01/2016
CHECKED:	LM