

GEN. TOLERANCES	0.5 - 6	±0.1	6 - 30	±0.2	30 - 120	±0.3	120 - 315	±0.5	315 - 1000	±0.8	1000 - 2000	±1.2	2000 - 4000	±2	4000 - 8000	±3
GEN. MACHINING	▽	0.4	▽	1.6	▽	3.2	6.3	▽	12.6	▽	25 ROUGH	▽		▽		

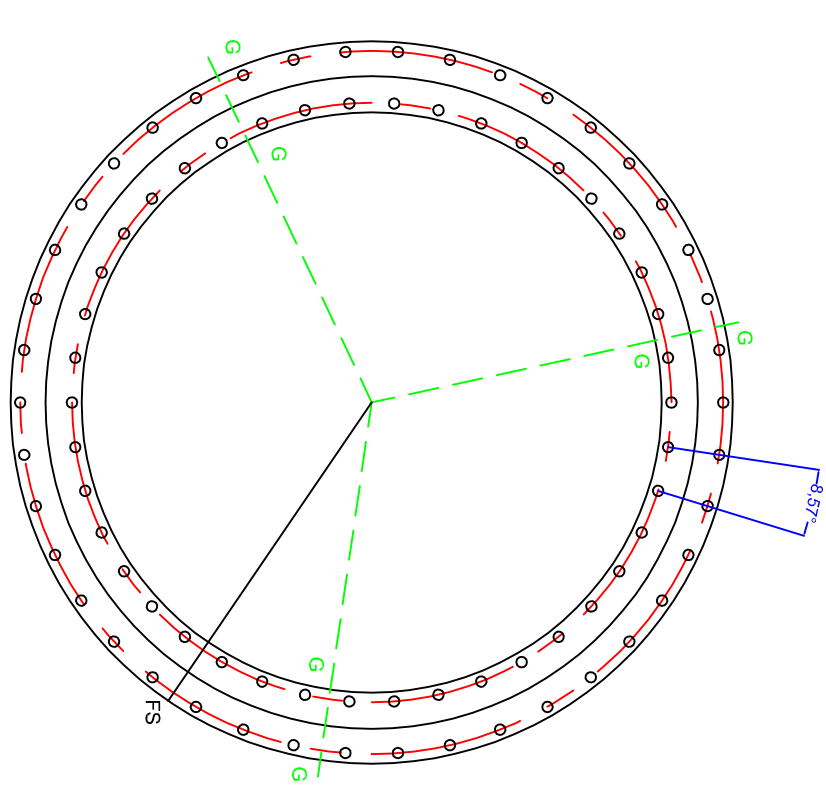
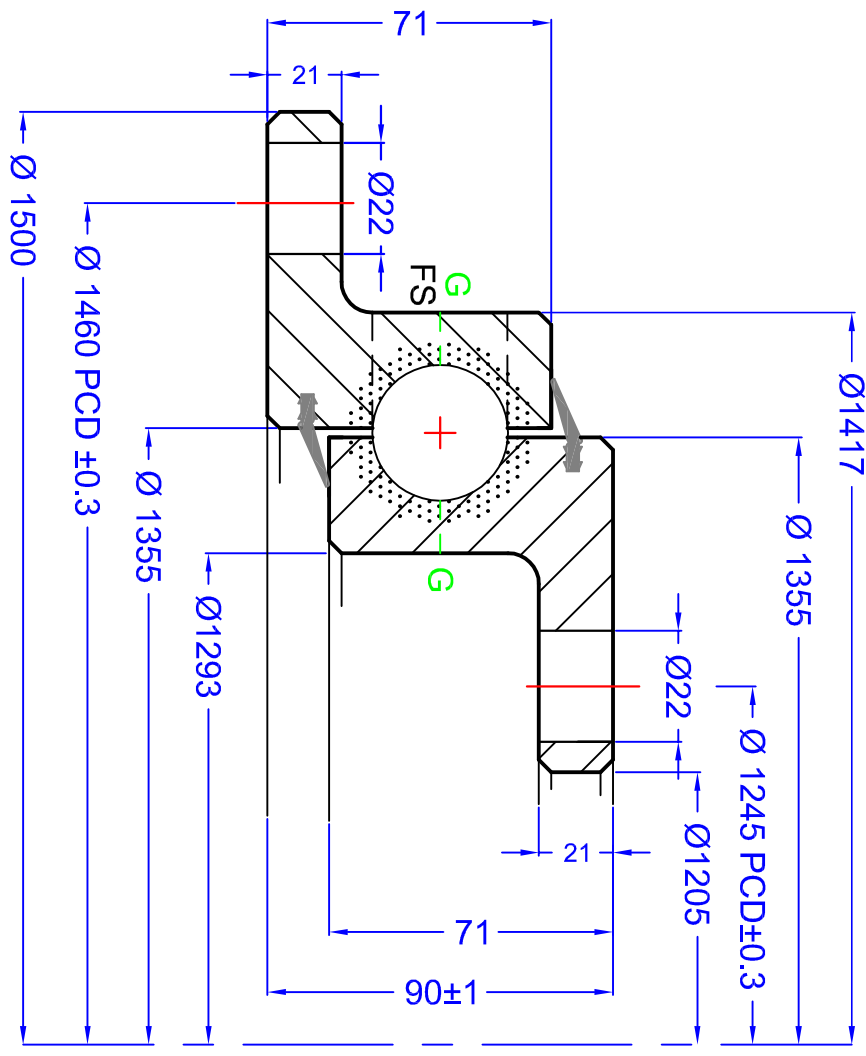
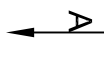

GEAR DATA

HARDED GEAR	MODULE (m)	Designed in accordance with designated QCB SLEWING RING STANDARDS													
NUMBER OF TEETH (z)	DP	Non toleranced dimensions to ISO 2768-1 m													
PRESSURE ANGLE (α)		All burrs and sharp edges to be removed. Standard corner chamfer 1mm x 45°													
ADDENDUM COEFFICIENT (fa)		Internal radial and axial clearance figures to QCB standard 2014 or revisions thereof													
PROFILE CORRECTION (km)		The HARPNESS GAP is to be indicated by stamped letter R or a PAINT mark on the exterior surface													
		The high point of gear eccentricity to be indicated by GREEN or BLUE paint on 3 teeth													

BOLT DATA

TRUNCATION (km)	KN	INNER	42 =	MOUNTING HOLES	Ø 22	TURNING TORQUE	Nm
PITCH CIRCLE DIAMETER	KN	OUTER	42 =	MOUNTING HOLES	Ø 22	MATERIAL	42CrMo4 Q&T
MEASUREMENT ON K TEETH	mm	GREASE HOLES	G'	2 X 3 M10		WEIGHT	186 kg (est)
RUNOUT NOT HARDED/HARDENED		LOADING PLUG	FS	SOFT ZONE	R	REFINISH (standard)	mm
		SEAL SIZE	TBA				

© NBC GROUP LTD. NOT TO BE COPIED WITHOUT PERMISSION

REV	DATE	MODIFICATION	REVISED BY
1			



SLEWING RINGS & DRIVES

Imported by NBC Group Ltd
 Orleton Lane, Wellington, Telford, TF1 2BG, UK
 P: 01962 222300 F: 01962 242938
 www.nbcgroup.co.uk

FUN 1500 32 00 AA LM

DRAWN:	LW
DATE:	20/01/2016
CHECKED:	LM

QCB® is a registered trademark of NBC Group Ltd
 QCB RS 11/2016