

| GEN. TOLERANCES | 0.5 - 6 | ±0.1 | 6 - 30 | ±0.2 | 30 - 120 | ±0.3 | 120 - 315 | ±0.5 | 315 - 1000 | ±0.8 | 1000 - 2000 | ±1.2     | 2000 - 4000 | ±2 | 4000 - 8000 | ±3 |
|-----------------|---------|------|--------|------|----------|------|-----------|------|------------|------|-------------|----------|-------------|----|-------------|----|
| GEN. MACHINING  | ✓       | 0.4  | ✓      | 1.6  | ✓        | 3.2  | ✓         | 6.3  | ✓          | 12.6 | ✓           | 25 ROUGH | ✓           |    |             |    |

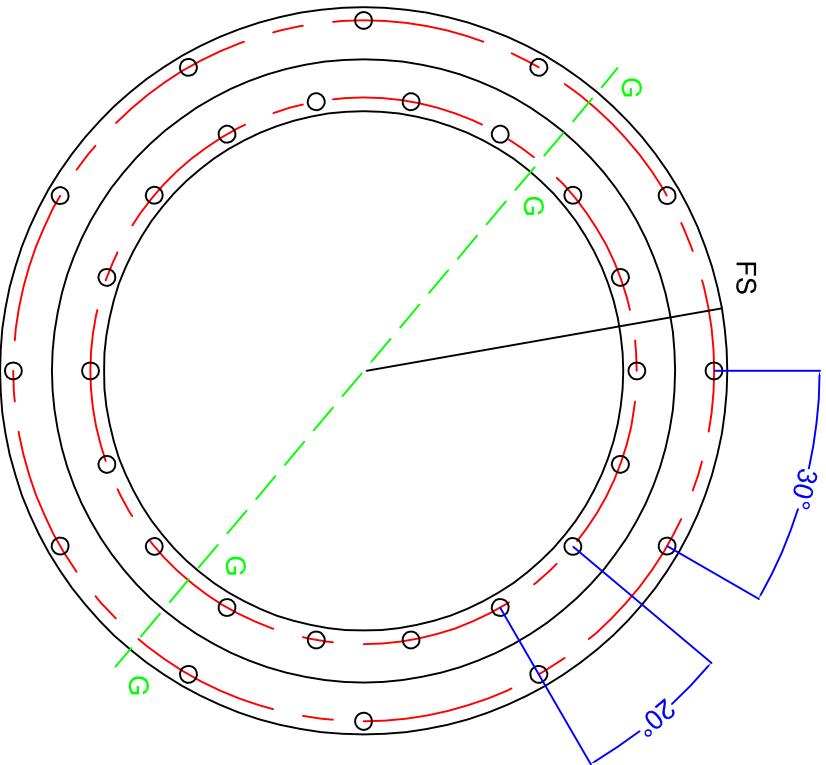
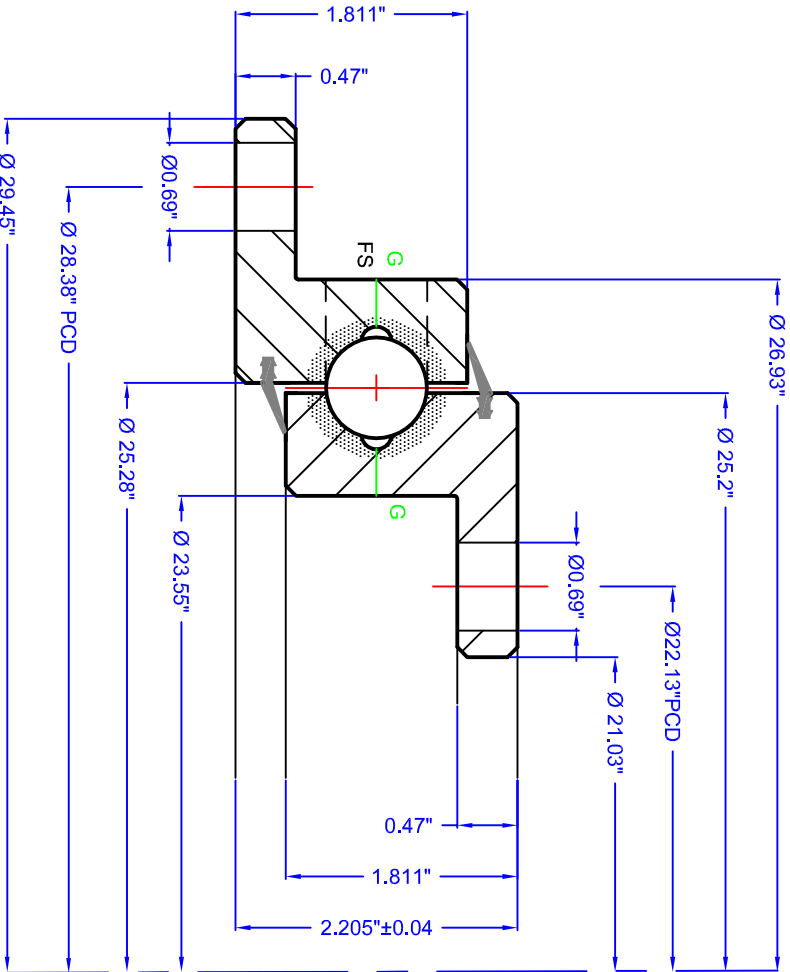
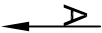

VIEW ON 'A' SHOWING DRILLING PATTERN AND OTHER DETAILS

| GEAR DATA  |    |  |  |  |  |  |  |  |  | Designed in accordance with designated QCB SLEWING RING STANDARDS                               |      |                   |         |                |  |  |  |  |  |
|--|----|--|--|--|--|--|--|--|--|---|------|-------------------|---------|----------------|--|--|--|--|--|
| HARDENED GEAR  |    |  |  |  |  |  |  |  |  | Non tolerated dimensions to ISO 2768-1 m  |      |                   |         |                |  |  |  |  |  |
| NUMBER OF TEETH (Z)                                  |    |  |  |  |  |  |  |  |  | All burrs and sharp edges to be removed; Standard corner chamfer 1mm x 45°                      |      |                   |         |                |  |  |  |  |  |
| PRESSURE ANGLE (α)                                   |    |  |  |  |  |  |  |  |  | Internal radial and axial clearance figures to QCB standard 2014 or revisions thereof           |      |                   |         |                |  |  |  |  |  |
|  |    |  |  |  |  |  |  |  |  | The HARDNESS GAP is to be indicated by stamped letter R or a PAINT mark on the exterior surface |      |                   |         |                |  |  |  |  |  |
|  |    |  |  |  |  |  |  |  |  | The high point of gear eccentricity to be indicated by GREEN or BLUE paint on 3 teeth           |      |                   |         |                |  |  |  |  |  |
| ADDENDUM COEFFICIENT (x)                             |    |  |  |  |  |  |  |  |  |   |      |                   |         |                |  |  |  |  |  |
| TRUNCATION (mm)                                      | mm |  |  |  |  |  |  |  |  |   |      |                   |         |                |  |  |  |  |  |
| PITCH CIRCLE DIAMETER                                | mm |  |  |  |  |  |  |  |  |   |      |                   |         |                |  |  |  |  |  |
| MEASUREMENT ON K TEETH                               | mm |  |  |  |  |  |  |  |  |   |      |                   |         |                |  |  |  |  |  |
| RUNOUT NOT HARDENED/HARDENED                         |    |  |  |  |  |  |  |  |  |   |      |                   |         |                |  |  |  |  |  |
| © NBC GROUP LTD. NOT TO BE COPIED WITHOUT PERMISSION |    |  |  |  |  |  |  |  |  |   |      |                   |         |                |  |  |  |  |  |
| BOLT DATA  |    |  |  |  |  |  |  |  |  |   |      |                   |         |                |  |  |  |  |  |
|  |    |  |  |  |  |  |  |  |  | INNER   | 18 = | MOUNTING HOLES    | Ø 0.69" | TURNING TORQUE |  |  |  |  |  |
|  |    |  |  |  |  |  |  |  |  | OUTER   | 12 = | MOUNTING HOLES    | Ø 0.69" | MATERIAL       |  |  |  |  |  |
|  |    |  |  |  |  |  |  |  |  |   |      | (2+2) 1/2"-28 UNF | WEIGHT  |                |  |  |  |  |  |
|  |    |  |  |  |  |  |  |  |  | LOADING PLUG  | 'FS' | SOFT ZONE         | 'R'     |                |  |  |  |  |  |
|  |    |  |  |  |  |  |  |  |  | SEAL SIZE   | TBA  |                   |         |                |  |  |  |  |  |

1

REV

DATE

MODIFICATION

REVISED BY

QCB

Bearings

SLEWING

RINGS &

DRIVES

Orleton Lane, Wellington, Telford, TF1 2BG, UK

P: 01962 222300 F: 01962 242938

www.nbcbgroup.co.uk

QCB® is a registered trademark of NBC Group Ltd

QCB RS 11/2016

FUN 748 20 61 CC LM

DATE: 13/05/2016

CHECKED: LJM