

| GEN. TOLERANCES | 0.5 - 6 | ±0.1 | 6 - 30 | ±0.2 | 30 - 120 | ±0.3 | 120 - 315 | ±0.5 | 315 - 1000 | ±0.8 | 1000 - 2000 | ±1.2 | 2000 - 4000 | ±2 | 4000 - 8000 | ±3 |
|-----------------|---------|------|--------|------|----------|------|-----------|------|------------|------|-------------|------|-------------|----|-------------|----|
| GEN. MACHINING | | 0.4 | | 1.6 | | 3.2 | | 6.3 | | 12.6 | 25 ROUGH | | | | | |

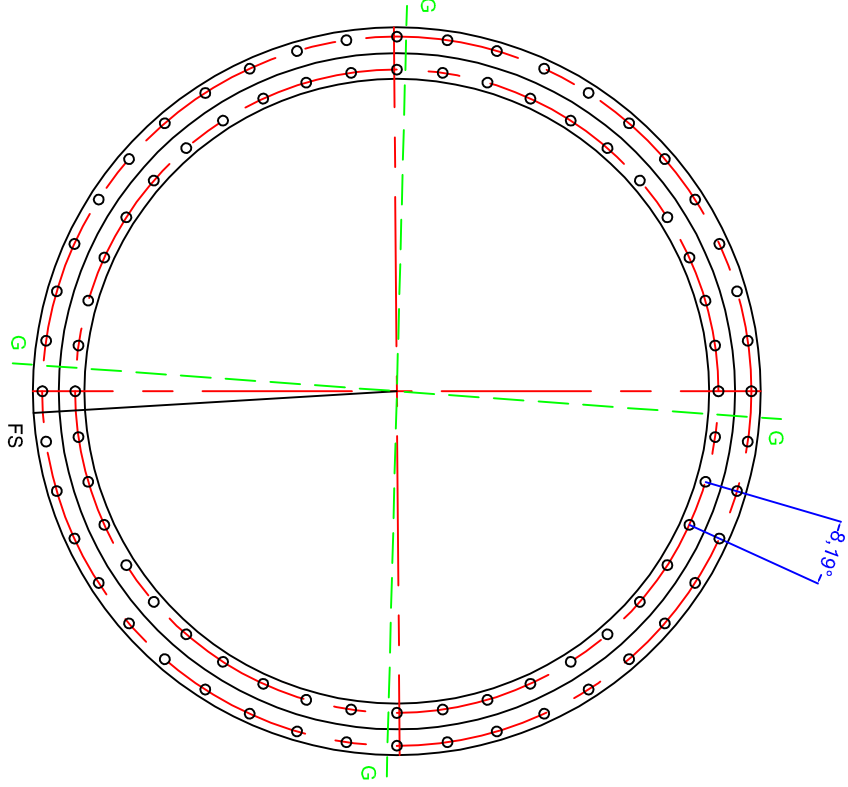
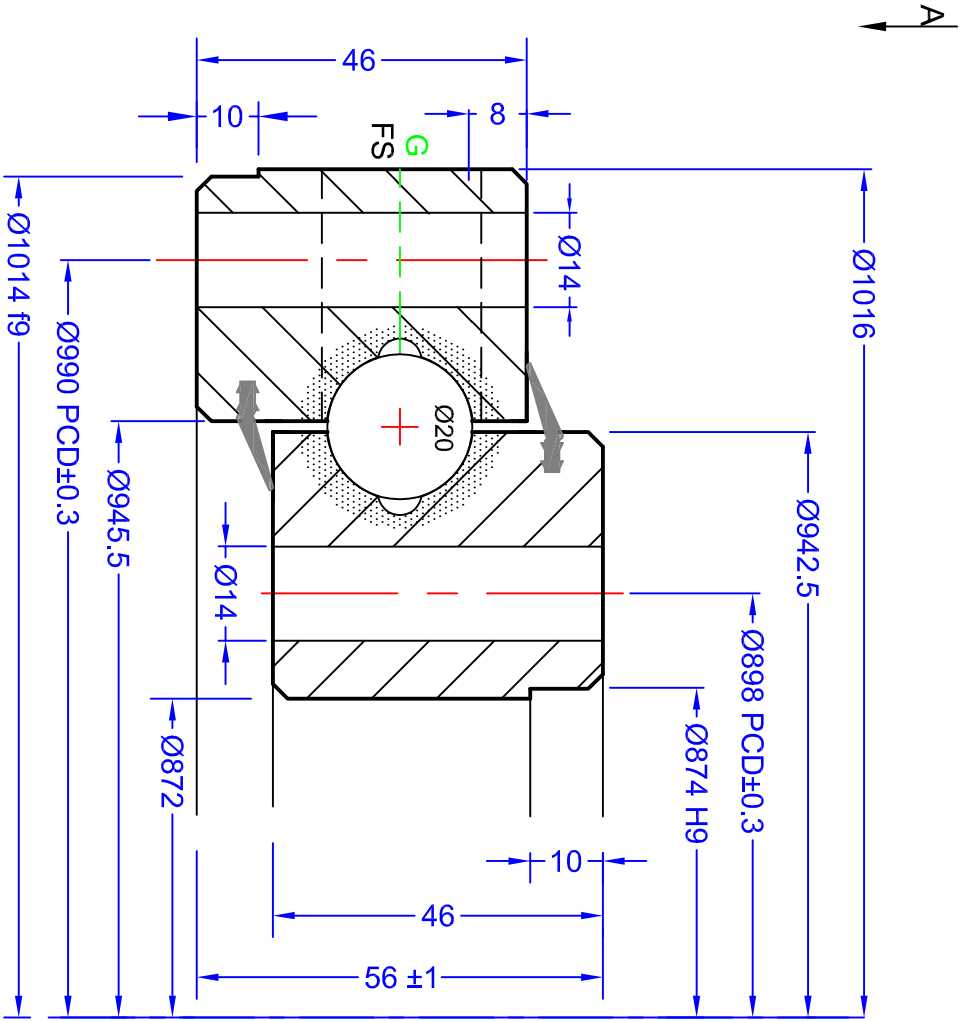

VIEW ON 'A' SHOWING DRILLING PATTERN AND OTHER DETAILS

| GEAR DATA | | Designed in accordance with designated QCB SLEWING RING STANDARDS | |
|--|-------------------------|---|------|
| HARDENED GEAR | | Non tolerated dimensions to ISO 2768-1 m | |
| NUMBER OF TEETH (z) | MODULE (m) | All burrs and sharp edges to be removed; Standard corner chamfer 1mm x 45° | |
| PRESSURE ANGLE (α) | DP | Internal radial and axial clearance figures to QCB standard 2014 or revisions thereof | |
| ADDENDUM COEFFICIENT (x) | | The HARDNESS GAP is to be indicated by stamped letter R or a PAINT mark on the exterior surface | |
| PROFILE CORRECTION (mm) | | The high point of gear eccentricity to be indicated by GREEN or BLUE paint on 3 teeth | |
| CALCULATED GEAR STRENGTH | | BOLT DATA | |
| TRUNCATION (mm) | F _z (Normal) | INNER | 44 = |
| PITCH CIRCLE DIAMETER | F _z (Max) | OUTER | 44 = |
| MEASUREMENT ON K TEETH | Pin Diameter | GREASE HOLES | G' |
| RUNOUT NOT HARDENED/HARDENED | | LOADING PLUG | 'FS' |
| © NBC GROUP LTD. NOT TO BE COPIED WITHOUT PERMISSION | | SEAL SIZE | TBA |

| REV | DATE | MODIFICATION | REVISD BY |
|-----|------|--------------|-----------|
| 1 | | | |

| | | | |
|---|--|-----------------------------------|--|
| QCB Bearings | | SLEWING RINGS & DRIVES | |
| Orelton Lane, Wellington, Telford, TF1 2BG, UK | | Imported by NBC Group Ltd | |
| P: 01962 222300 F: 01962 242938 | | www.nbcgroup.co.uk | |
| QCB® is a registered trademark of NBC Group Ltd | | DRAWN: LJM | |
| DATE: 2/12/2015 | | CHECKED: LJM | |

| | | | |
|-----------------------------|--|----------------|--|
| SUN 1016 20 01 AA LM | | QCB RS 11/2016 | |
|-----------------------------|--|----------------|--|