

GEN. TOLERANCES	0.5 - 6	±0.1	6 - 30	±0.2	30 - 120	±0.3	120 - 315	±0.5	315 - 1000	±0.8	1000 - 2000	±1.2	2000 - 4000	±2	4000 - 8000	±3
GEN. MACHINING		0.4		1.6		3.2		6.3		12.6	25 ROUGH					

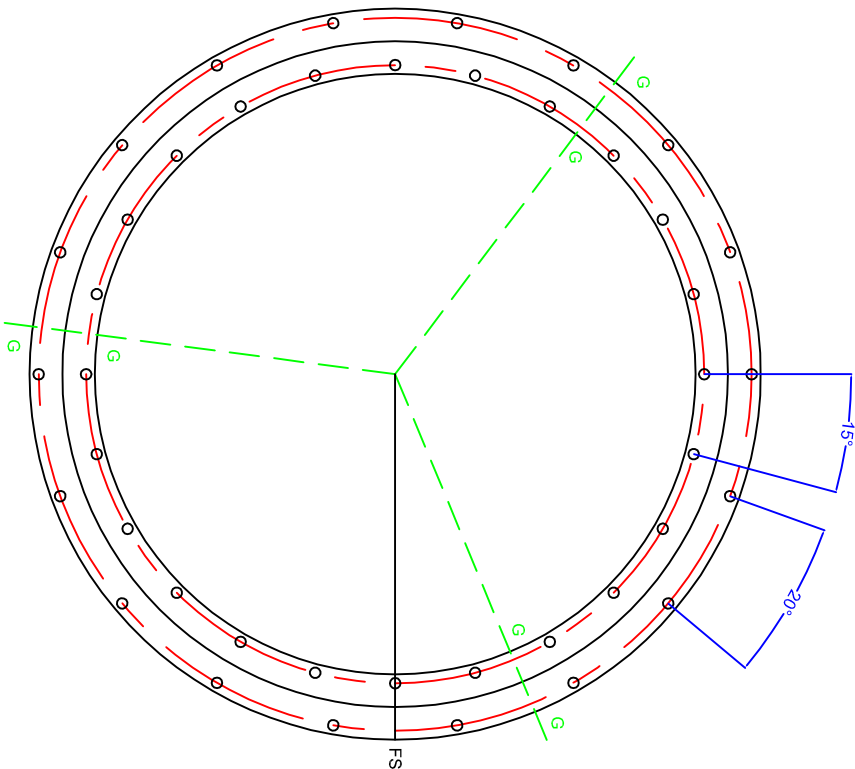
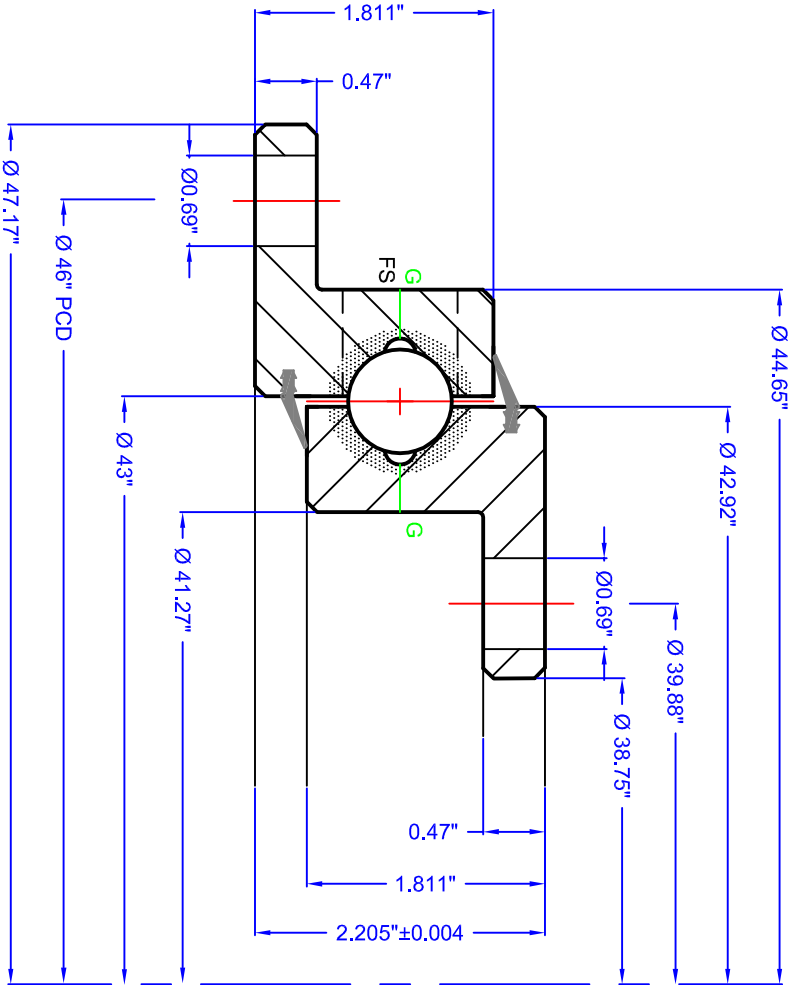
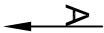

VIEW ON 'A' SHOWING DRILLING PATTERN AND OTHER DETAILS

GEAR DATA				Designed in accordance with designated QCB SLEWING RING STANDARDS			
HARDENED GEAR		MODULE (m)		Non tolerated dimensions to ISO 2768-1 m			
NUMBER OF TEETH (Z)		DP		All burrs and sharp edges to be removed; Standard corner chamfer 1mm x 45°			
PRESSURE ANGLE (α)				Internal radial and axial clearance figures to QCB standard 2014 or revisions thereof			
ADDENDUM COEFFICIENT (x)				The HARDNESS GAP is to be indicated by stamped letter R or a PAINT mark on the exterior surface			
PROFILE CORRECTION (y)				The high point of gear eccentricity to be indicated by GREEN or BLUE paint on 3 teeth			
CALCULATED GEAR STRENGTH				BOLT DATA			
TRUNCATION (mm)		F _z (Normal)		INNER	24 =	MOUNTING HOLES	Ø0.69"
PITCH CIRCLE DIAMETER		F _z (Max)		OUTER	18 =	MOUNTING HOLES	Ø0.69"
MEASUREMENT ON K TEETH		Pin Diameter		GREASE HOLES	'G'	(3+3) 1/4"-28 UNF	
RUNOUT NOT HARDENED/HARDENED				LOADING PLUG	'FS'	SOFT ZONE	'R'
© NBC GROUP LTD. NOT TO BE COPIED WITHOUT PERMISSION				SEAL SIZE	TBA		

REV	DATE	MODIFICATION	REVISED BY
1			

QCB
Bearings

SLEWING
RINGS &
DRIVES

Imported by NBC Group Ltd

Orleton Lane, Wellington, Telford, TF1 2BG, UK

P: 01962 222300 F: 01962 242938

www.nbgroup.co.uk

QCB® is a registered trademark of NBC Group Ltd

QCB RS 11/2016

DRAWN:

DATE:

CHECKED:

LW

13/05/2016

LJM