

GEN. TOLERANCES	0.5 - 6	±0.1	6 - 30	±0.2	30 - 120	±0.3	120 - 315	±0.5	315 - 1000	±0.8	1000 - 2000	±1.2	2000 - 4000	±2	4000 - 8000	±3
GEN. MACHINING	✓	0.4	✓	1.6	✓	3.2	✓	6.3	✓	12.6	25 ROUGH	✓	✓	✓	✓	✓

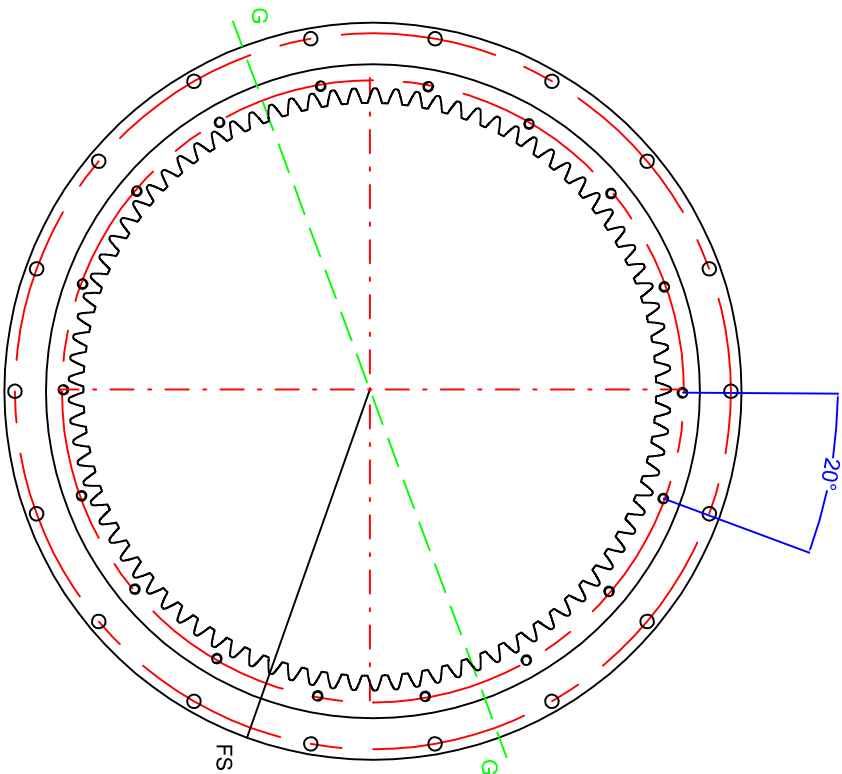
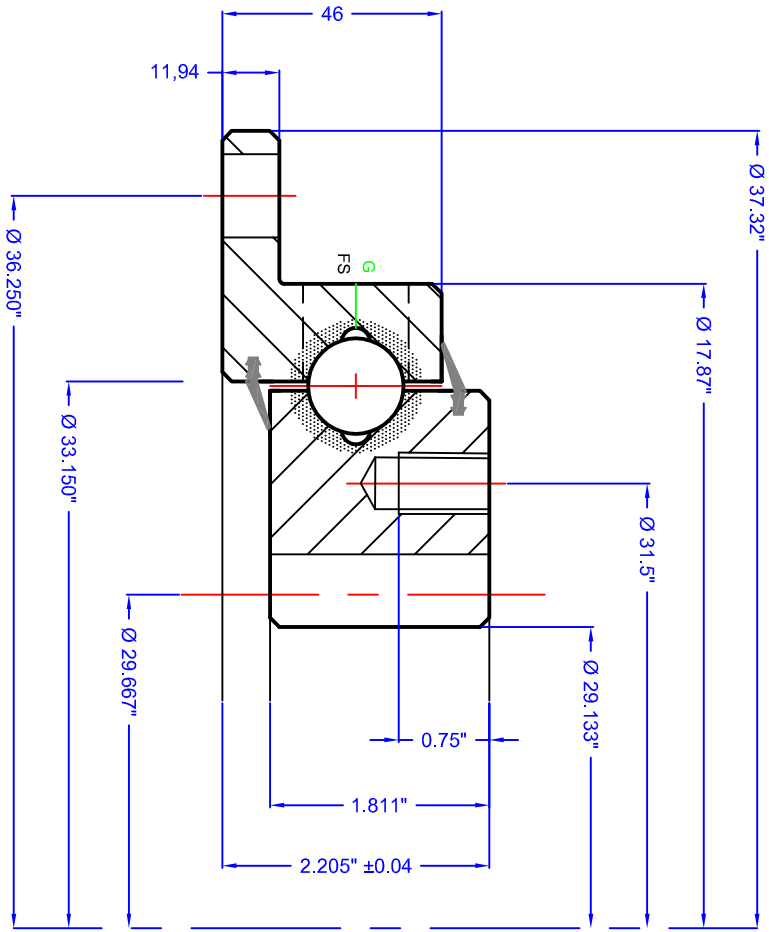
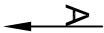

VIEW ON 'A' SHOWING DRILLING PATTERN AND OTHER DETAILS

GEAR DATA		SPUR	WORM	HELICAL
HARDENED GEAR	NO			
NUMBER OF TEETH (Z)	89		MODULE (m)	
PRESSURE ANGLE (α)	20°		DP	3
ADDENDUM COEFFICIENT (X)				
PROFILE CORRECTION (Ym)				
BOLT DATA				
Designed in accordance with designated QCB SLEWING RING STANDARDS				
Non tolerated dimensions to ISO 2768-1 m				
All burrs and sharp edges to be removed; Standard corner chamfer 1mm x 45°				
Internal radial and axial clearance figures to QCB standard 2014 or revisions thereof				
The HARPENESS GAP is to be indicated by stamped letter R or a PAINT mark on the exterior surface				
The high point of gear eccentricity to be indicated by GREEN or BLUE paint on 3 teeth				
CALCULATED GEAR STRENGTH				
TRUNCATION (mm)		Fz (Normal)	KN	INNER
PITCH CIRCLE DIAMETER	29.667"	Fz (Max)	KN	OUTER
MEASUREMENT ON K TEETH	mm	Pin Diameter	mm	
RUNOUT NOT HARDENED/HARDENED		LOADING PLUG	'FS'	SOFT ZONE
© NBC GROUP LTD. NOT TO BE COPIED WITHOUT PERMISSION				
SEAL SIZE				
TBA				

REV	DATE	MODIFICATION	REVISD BY
1			

QCB
Bearings

SLEWING
RINGS &
DRIVES

Orleton Lane, Wellington, Telford, TF1 2BG, UK
P: 01952 222300 F: 01952 242938
www.nbcbgroup.co.uk

QCB® is a registered trademark of NBC Group Ltd

FIG 948 20 61 AA LM

QCB RS 11/2016

DRAWN: LW

DATE: 13/09/2016

CHECKED: LLM