

GEN. TOLERANCES	0.5 - 6	±0.1	6 - 30	±0.2	30 - 120	±0.3	120 - 315	±0.5	315 - 1000	±0.8	1000 - 2000	±1.2	2000 - 4000	±2	4000 - 8000	±3
GEN. MACHINING	√	0.4	√	1.6	√	3.2	√	6.3	√	12.6	√	25 ROUGH	√			

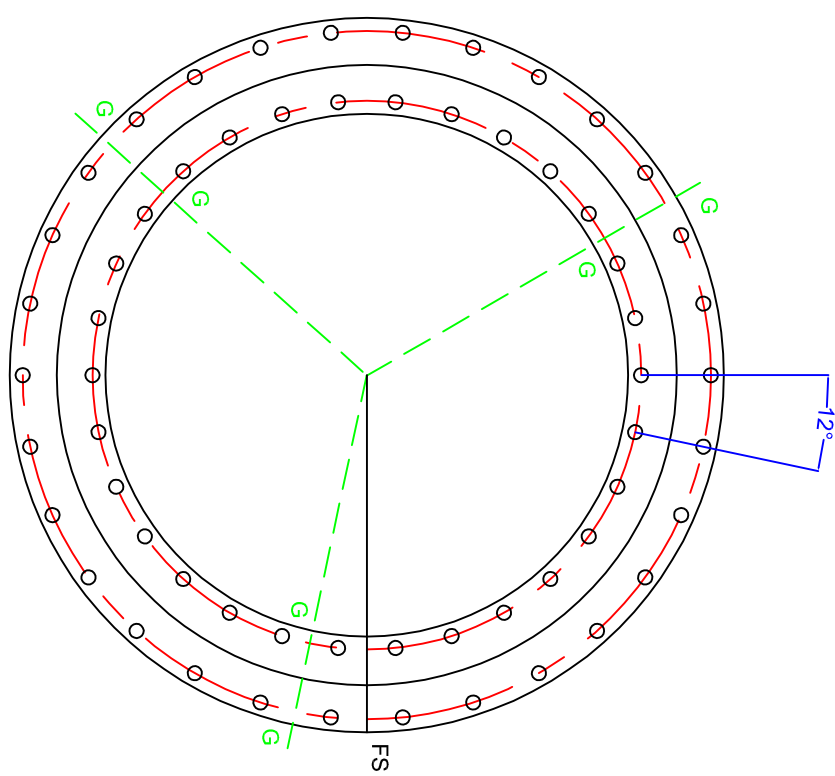
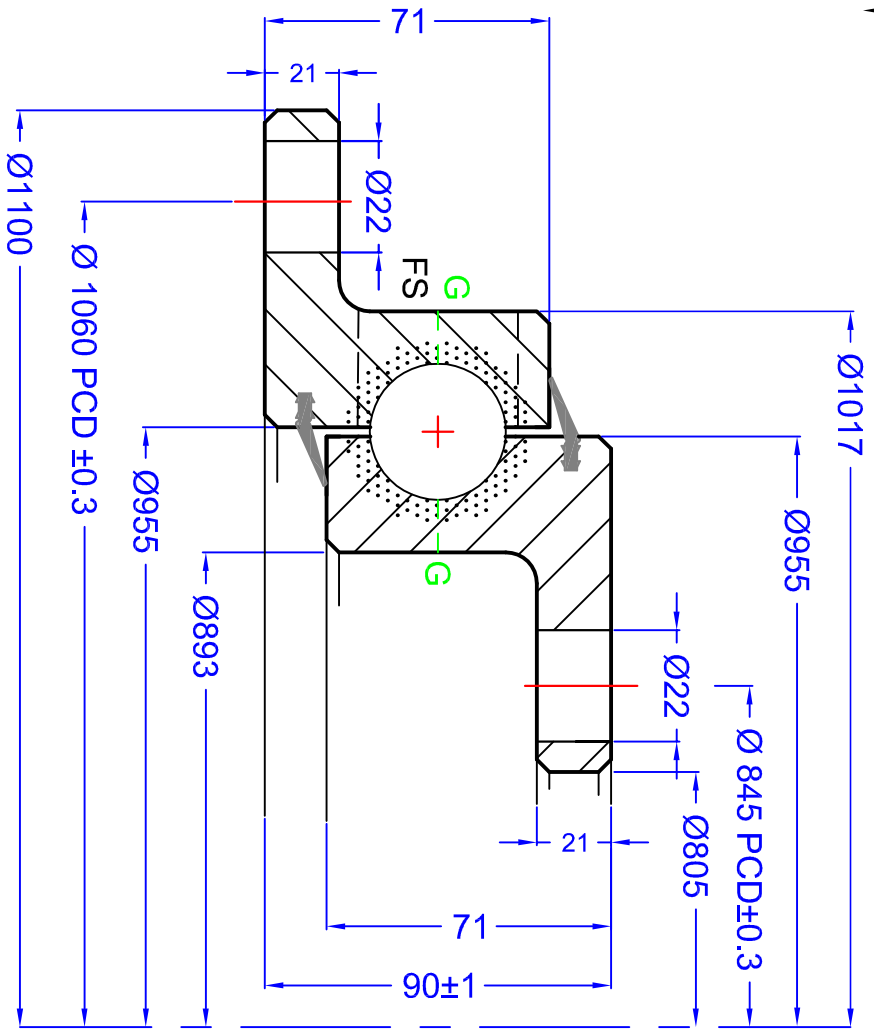
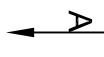

VIEW ON 'A' SHOWING DRILLING PATTERN AND OTHER DETAILS

**GEAR DATA**

HARDED GEAR	MODULE (m)	0.4
NUMBER OF TEETH (z)	DP	
PRESSURE ANGLE (α)		
ADDENDUM COEFFICIENT (fa)		
PROFILE CORRECTION (km)		
TRUNCATION (km)		
MEASUREMENT ON K TEETH		
RUNOUT NOT HARDED/HARDED		
DESIGNED IN ACCORDANCE WITH DESIGNATED QCB SLEWING RING STANDARDS		
Non tolerated dimensions to ISO 2768-1 m		
All burrs and sharp edges to be removed. Standard corner chamfer 1mm x 45°		
Internal radial and axial clearance figures to QCB standard 2014 or revisions thereof		
The HARFENESS GAP is to be indicated by stamped letter R or a PAINT mark on the exterior surface		
The High point of gear eccentricity to be indicated by GREEN or BLUE paint on 3 teeth		
<b>BOLT DATA</b>		
INNER	MOUNTING HOLES	Ø 22
OUTER	MOUNTING HOLES	Ø 22
GREASE HOLES		2 X 3 M10
LOADING PLUG	SOFT ZONE	R1
SEAL SIZE		TBA
AXIAL PLAY		0.12-0.28 mm
RADIAL PLAY		0.12-0.28 mm
TURNING TORQUE		Nm
MATERIAL		42CrMo4 Q&T
WEIGHT		131 kg (est)
REFINISH (standard)		mm

REV	DATE	MODIFICATION	REVISED BY
1			

**QCB Bearings**

SLEWING RINGS & DRIVES

Imported by NBC Group Ltd

Orelton Lane, Wellington, Telford, TF1 2BG, UK

P: 01962 222300 F: 01962 242938

www.nbcgroup.co.uk

QCB® is a registered trademark of NBC Group Ltd

**FUN 1100 32 00 AA LM**

QCB RS 112016

DRAWN: LW

DATE: 19/01/2016

CHECKED: LJM

© NBC GROUP LTD. NOT TO BE COPIED WITHOUT PERMISSION