

GEN. TOLERANCES	0.5 - 6	±0.1	6 - 30	±0.2	30 - 120	±0.3	120 - 315	±0.5	315 - 1000	±0.8	1000 - 2000	±1.2	2000 - 4000	±2	4000 - 8000	±3
GEN. MACHINING	▽	0.4	▽	1.6	▽	3.2	6.3	▽	12.6	▽	25 ROUGH	▽		▽		

A

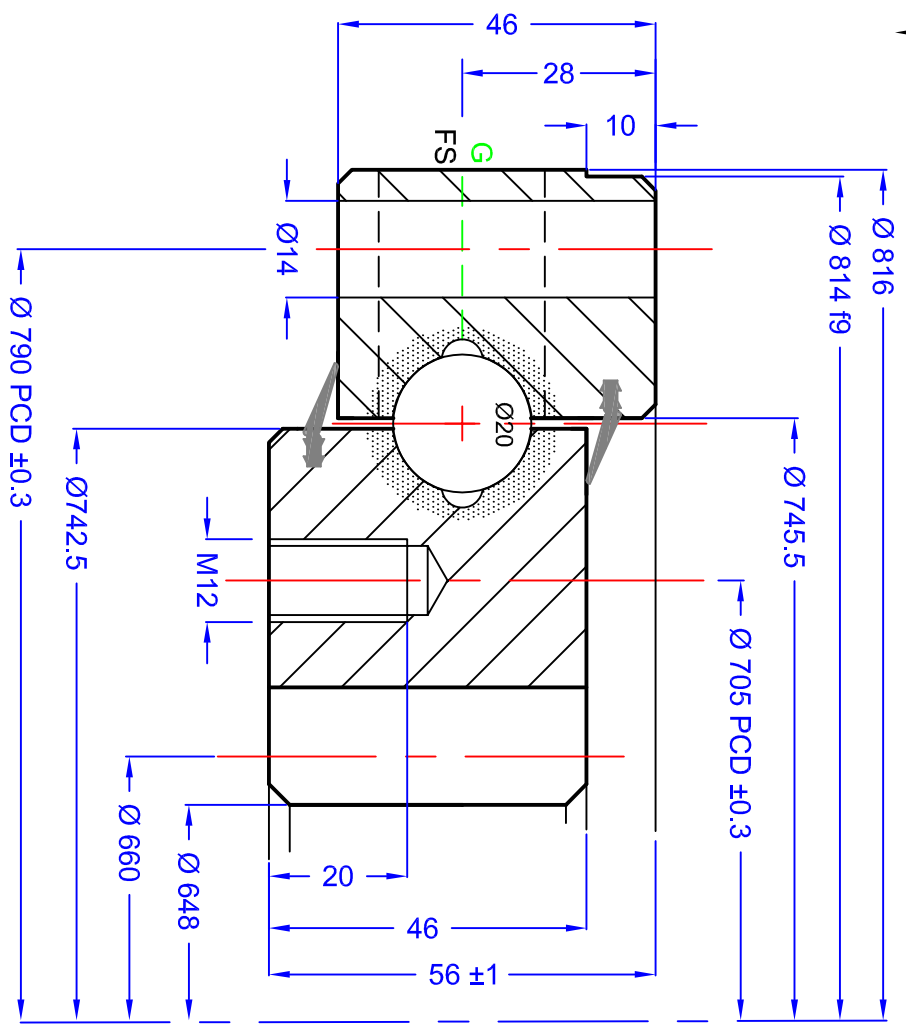

GEAR DATA

HARDED GEAR	NO	WORM	HELICAL	Designed in accordance with designated QCB SLEWING RING STANDARDS												
NUMBER OF TEETH (z)	110	MODULE (m)	6	Non tolerated dimensions to ISO 2768-1 m												
PRESSURE ANGLE (α)	20°	DP		All burrs and sharp edges to be removed; Standard chamfer 1mm x 45°												
ADDENDUM COEFFICIENT (α)	0	Internal radial and axial clearance figures to QCB standard 2014 or revisions thereof														
PROFILE CORRECTION (km)	0	The HARFNESS GAP is to be indicated by stamped letter R or a PAINT mark on the exterior surface														
TRUNCATION (km)	0	The High point of gear eccentricity to be indicated by GREEN or BLUE paint on 3 teeth														

BOLT DATA

INNER	40 =	MOUNTING HOLES	M12	AXIAL PLAY	0.12-0.28 mm
OUTER	40 =	MOUNTING HOLES	Ø 14	RADIAL PLAY	0.12-0.28 mm
GREASE HOLES	G'	WEIGHT	4 X M8	TURNING TORQUE	Nm
LOADING PLUG	'FS'	SOFT ZONE	'R'	MATERIAL	42CrMo4 Q&T
SEAL SIZE	TBA			WEIGHT	58 Kg (est)
				DEPTH OF HARDENING (standard)	mm

© NBC GROUP LTD. NOT TO BE COPIED WITHOUT PERMISSION

VIEW ON 'A' SHOWING DRILLING PATTERN AND OTHER DETAILS

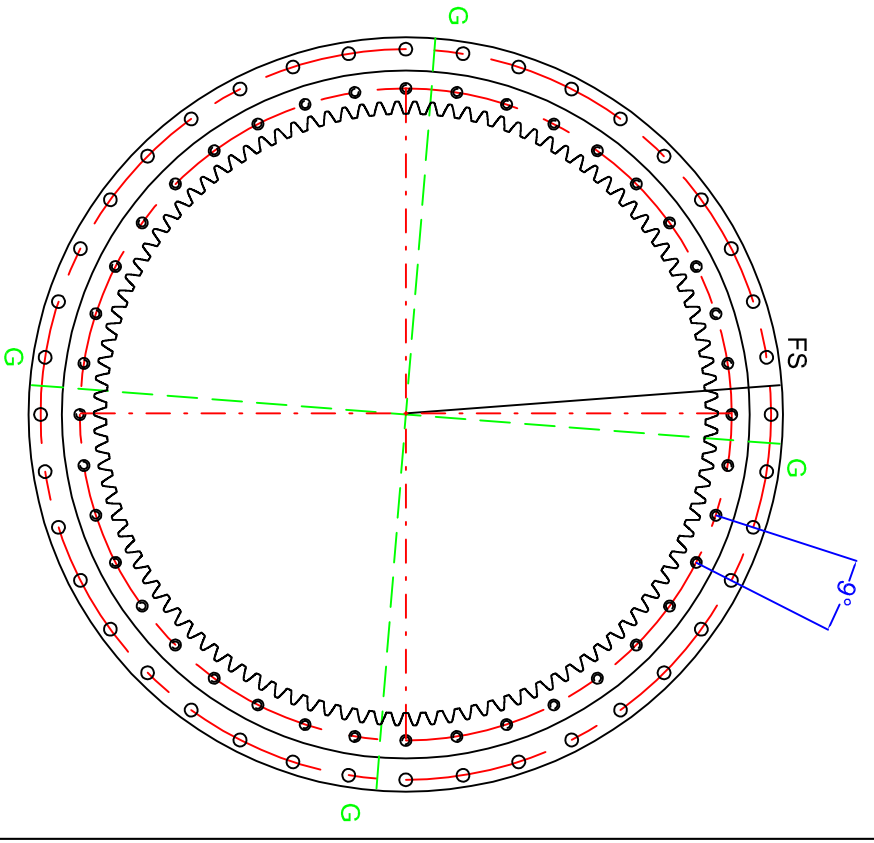

REV	DATE	MODIFICATION	REVISED BY
1			



SLEWING RINGS & DRIVES

Imported by NBC Group Ltd
 Orleton Lane, Wellington, Teitford, TF1 2BG, UK
 P: 01962 222300 F: 01962 242938
 www.nbcgroup.co.uk

SIG 816 20 01 AA LM

QCB is a registered trademark of NBC Group Ltd
 QCB RS 11/2016

DRAWN:	LW
DATE:	04/01/2016
CHECKED:	LM