

GEN. TOLERANCES	0.5 - 6	±0.1	6 - 30	±0.2	30 - 120	±0.3	120 - 315	±0.5	315 - 1000	±0.8	1000 - 2000	±1.2	2000 - 4000	±2	4000 - 8000	±3
GEN. MACHINING	0.4	▽	1.6	▽	3.2	▽	6.3	▽	12.6	▽	25 ROUGH	▽		▽		▽

Slewing Drive Performance Data	
Worm Gear Ratio	85:1
Rated Output Torque	8000 Nm
Rated output speed	2.5 rpm
Tilting Moment Torque (Max.)	67.8 kNm
Holding Torque	48 kNm
Axial Load (Max.) / Radial load (Max)	555 kN / 222 kN
Self Locking Gears	Yes
Weight	73 kg
Tracking precision	≤ 0.17°
Efficiency	40%

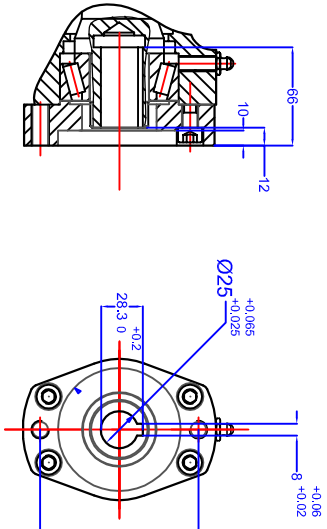
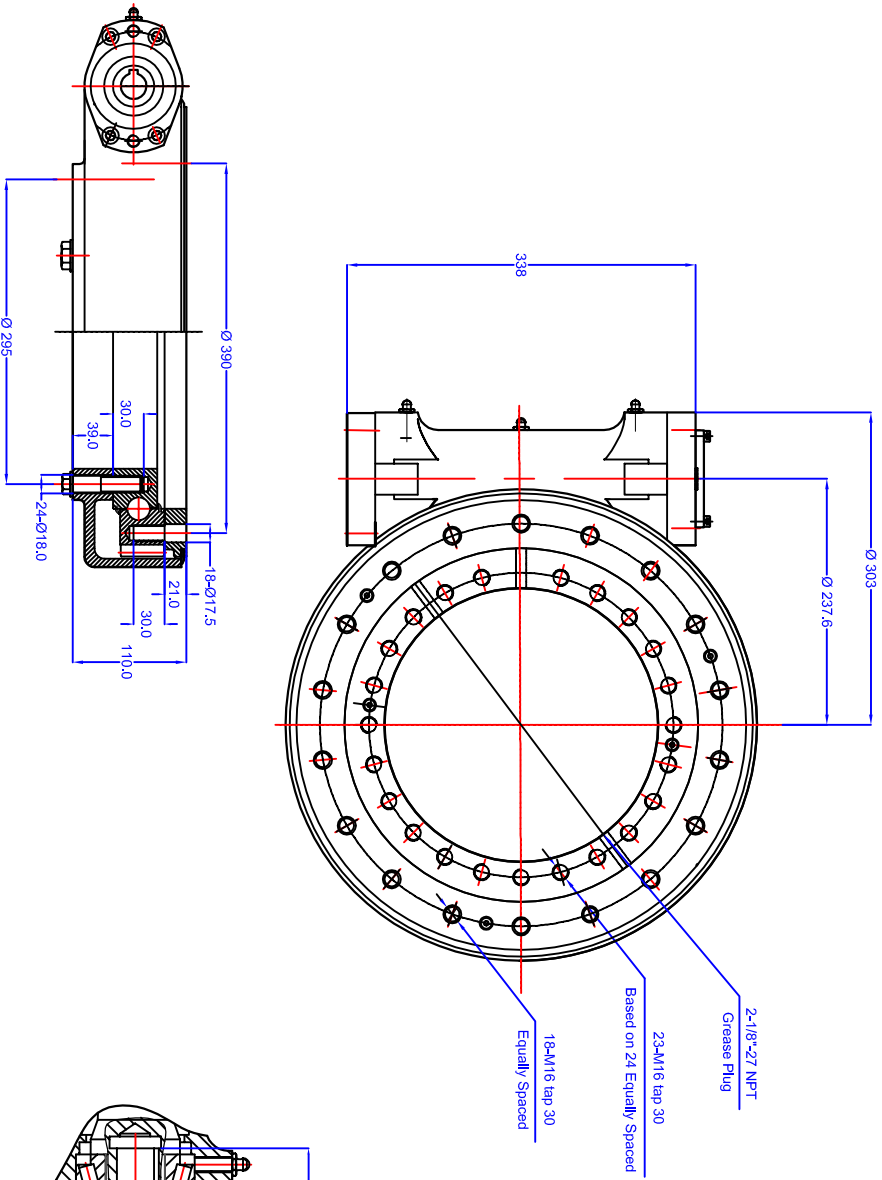
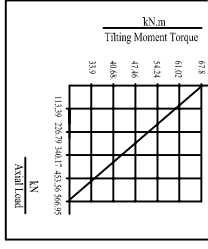

GEAR DATA	SPUR	WORM	HELICAL
	WORM GEAR RATIO	85:1	
OUTPUT TORQUE	8 kNm		
HOLDBACK TORQUE	67.8 kNm		
RATED OUTPUT SPEED	< 2.5 rpm		
TRACKING PRECISION	≤ 0.17°		
MAXIMUM MOMENT LOAD			

BOLT DATA	INNER	24-1 =	MOUNTING HOLES	M16 CS18	AXIAL PLAY	
	OUTER	18 =	MOUNTING HOLES	M16CS17.5	RADIAL PLAY	
GREASE HOLES	G'				TURNING TORQUE	
LOADING PLUG	'FS'				MATERIAL	
			SOFT ZONE	R'	WEIGHT	73 kg
			SEAL SIZE	TBA		mm

Designed in accordance with designated QCB SLEWING RING STANDARDS
 Non toleranced dimensions to ISO 2768-1 m
 All burrs and sharp edges to be removed. Standard corner chamfer 1mm x 45°
 Internal radial and axial clearance figures to QCB standard 2014 or revisions thereof.
 The HARDNESS GAP is to be indicated by stamped letter R or a PAINT mark on the exterior surface.
 The high point of gear eccentricity to be indicated by GREEN or BLUE paint on 3 teeth

© NBC GROUP LTD. NOT TO BE COPIED WITHOUT PERMISSION	
REV	DATE
MODIFICATION	
REVISED BY	

QCB Bearings SLEWING RINGS & DRIVES

Orleton Lane, Wellington, Telford, TF1 2BG, UK
 P: 01962 222300 F: 01962 242938
 www.nbogroup.co.uk

QCB® is a registered trademark of NBC Group Ltd

OCB or NBC DRAWING NUMBER	WGSE 14A 85 25 HR
DRAWN:	LJM
DATE:	12/07/2016
CHECKED:	LJM