

GEN. TOLERANCES		0.5 - 6	±0.1	6 - 30	±0.2	30 - 120	±0.3	120 - 315	±0.5	315 - 1000	±0.8	1000 - 2000	±1.2	2000 - 4000	±2	4000 - 8000	±3
GEN. MACHINING	√	0.4	√	1.6	√	3.2	√	6.3	√	12.6	√	25 ROUGH	√		√		

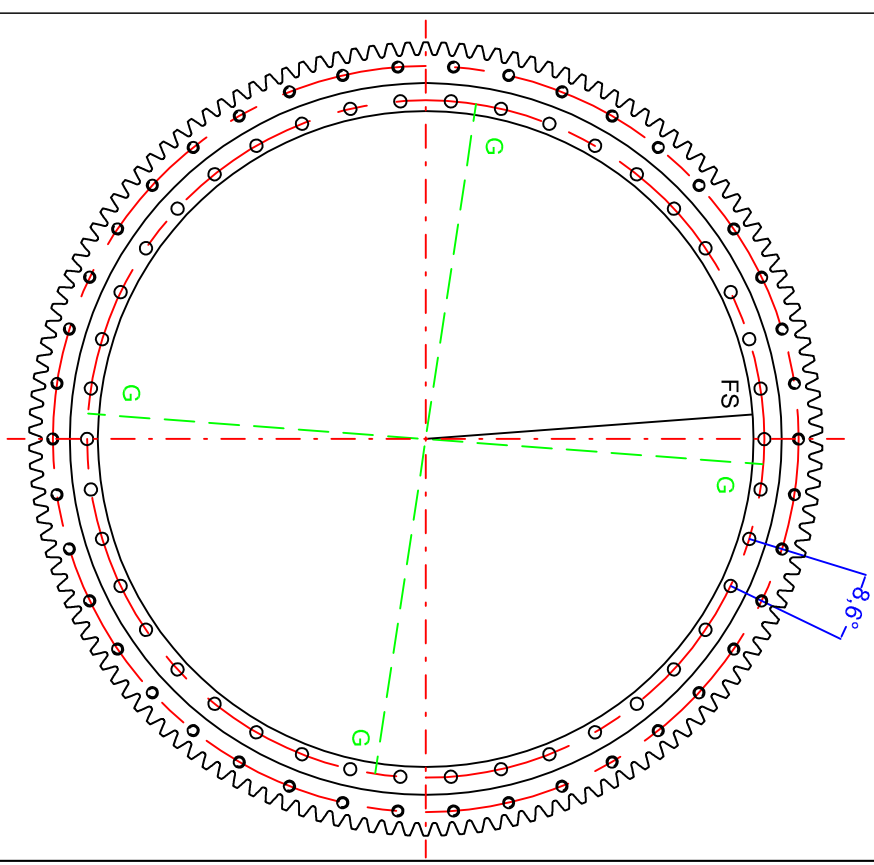
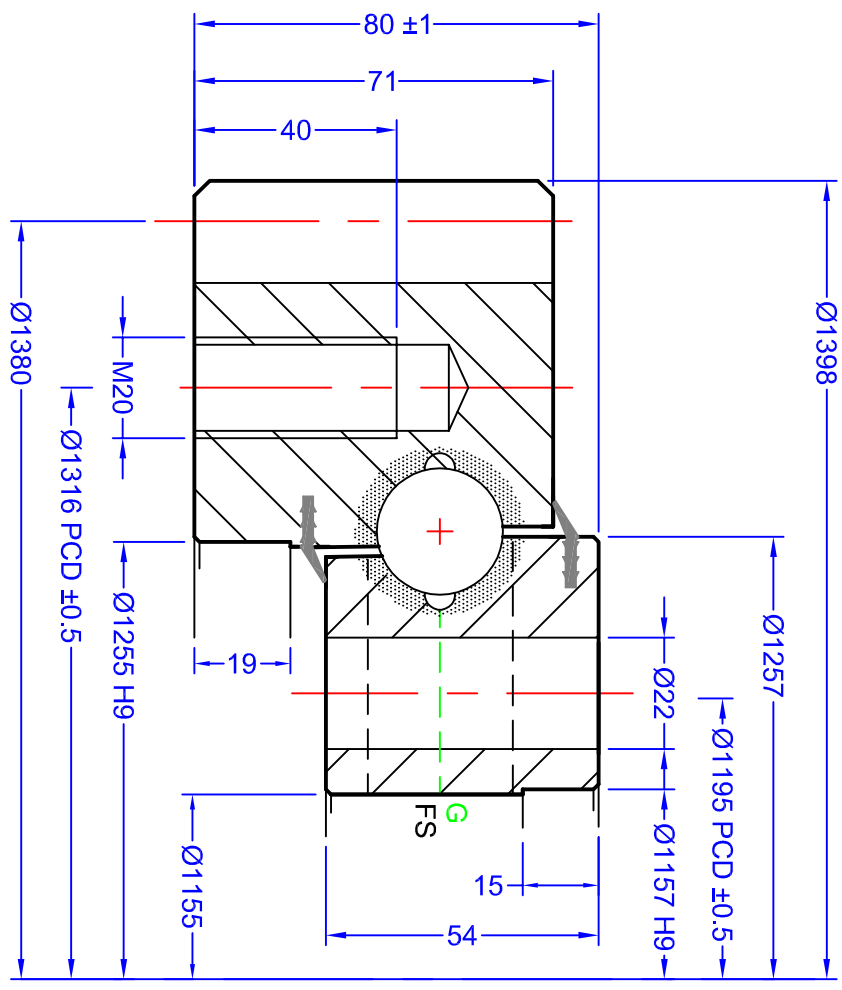
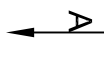

GEAR DATA

HARDED GEAR	NO	MODULE (m)	10
NUMBER OF TEETH (z)	138	DP	
PRESSURE ANGLE (α)	20°		
ADDENDUM COEFFICIENT (α)	0		
PROFILE CORRECTION (xm)	0		
TRUNCATION (km)	0		
MEASUREMENT ON K TEETH	1380 mm		
RUNOUT NOT HARDED/HARDED			

BOLT DATA

INNER	42 =	MOUNTING HOLES	Ø 22	TURNING TORQUE	Nm
OUTER	42 =	MOUNTING HOLES	M20	MATERIAL	42CrNiMo4 Q&T
GREASE HOLES	G'	4 X M8		WEIGHT	204 kg (est)
LOADING PLUG	FS'	SOFT ZONE	R'		
SEAL SIZE	TBA				

REV	DATE	MODIFICATION	REVISED BY
1			

QCB Bearings

SLEWING RINGS & DRIVES

Orleton Lane, Wellington, Telford, TF1 2BG, UK

P: 01962 222300 F: 01962 242938

www.nbcbgroup.co.uk

QCB® is a registered trademark of NBC Group Ltd

SEG 1400 25 01 AA LM

DRAWN:	LW
DATE:	22/12/2015
CHECKED:	LM

© NBC GROUP LTD. NOT TO BE COPIED WITHOUT PERMISSION

OCB or NBC DRAWING NUMBER

Designed in accordance with designated QCB SLEWING RING STANDARDS

Non tolerated dimensions to ISO 2768-1 m

All burrs and sharp edges to be removed. Standard corner chamfer 1mm x 45°

Internal radial and axial clearance figures to QCB standard 2014 or revisions thereof

The HARNESS GAP is to be indicated by stamped letter R or a PAINT mark on the exterior surface

The high point of gear eccentricity to be indicated by GREEN or BLUE paint on 3 teeth