

GEN. TOLERANCES		0.5 - 6	±0.1	6 - 30	±0.2	30 - 120	±0.3	120 - 315	±0.5	315 - 1000	±0.8	1000 - 2000	±1.2	2000 - 4000	±2	4000 - 8000	±3
GEN. MACHINING	√	0.4	√	1.6	√	3.2	√	6.3	√	12.6	√	25 ROUGH	√		√		

A

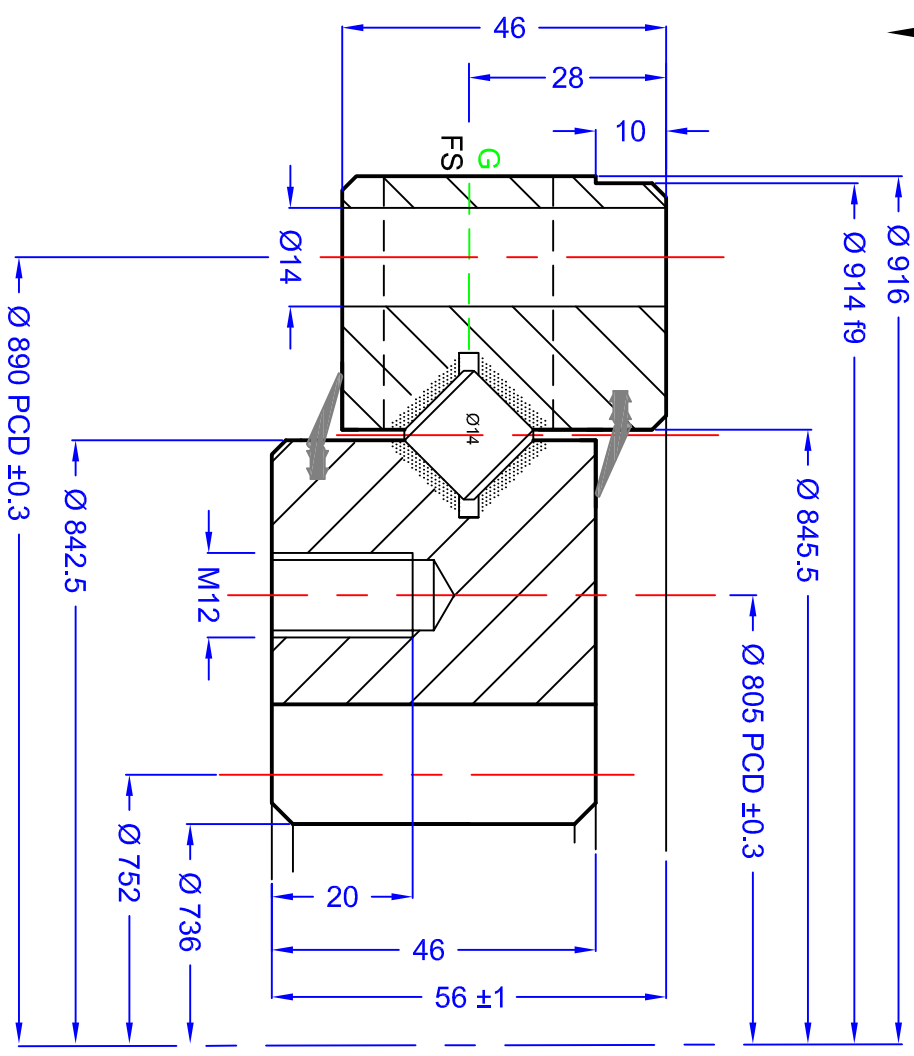

GEAR DATA	SPUR	WORM	HELICAL
-----------	------	------	---------

HARDED GEAR	NO	MODULE (m)	8
NUMBER OF TEETH (z)	94	DP	
PRESSURE ANGLE (α)	20°		
ADDENDUM COEFFICIENT (α)	0		
PROFILE CORRECTION (xm)	0		
TRUNCATION (km)	0		
PITCH CIRCLE DIAMETER	752 mm		
MEASUREMENT ON K TEETH	mm	Pin Diameter	mm
RUNOUT NOT HARDED/HARDED		LOADING PLUG	'FS'
		SOFT ZONE	'R'
		SEAL SIZE	TBA

Designed in accordance with designated QCB SLEWING RING STANDARDS  
 Non toleranced dimensions to ISO 2768-1 m  
 All burrs and sharp edges to be removed; Standard corner chamfer 1mm x 45°  
 Internal radial and axial clearance figures to QCB standard 2014 or revisions thereof  
 The HARFNESS GAP is to be indicated by stamped letter R or a PAINT mark on the exterior surface  
 The high point of gear eccentricity to be indicated by GREEN or BLUE paint on 3 teeth

**BOLT DATA**

INNER	40 =	MOUNTING HOLES	M12	AXIAL PLAY	0.12-0.28 mm
OUTER	40 =	MOUNTING HOLES	Ø 14	RADIAL PLAY	0.12-0.28 mm
GREASE HOLES	'G'		4 X M8	TURNING TORQUE	Nm
LOADING PLUG	'FS'			MATERIAL	42CrMo4 Q&T
				WEIGHT	69 kg (est)
				REFINISH (standard)	
					mm

© NBC GROUP LTD. NOT TO BE COPIED WITHOUT PERMISSION

VIEW ON 'A' SHOWING DRILLING PATTERN AND OTHER DETAILS

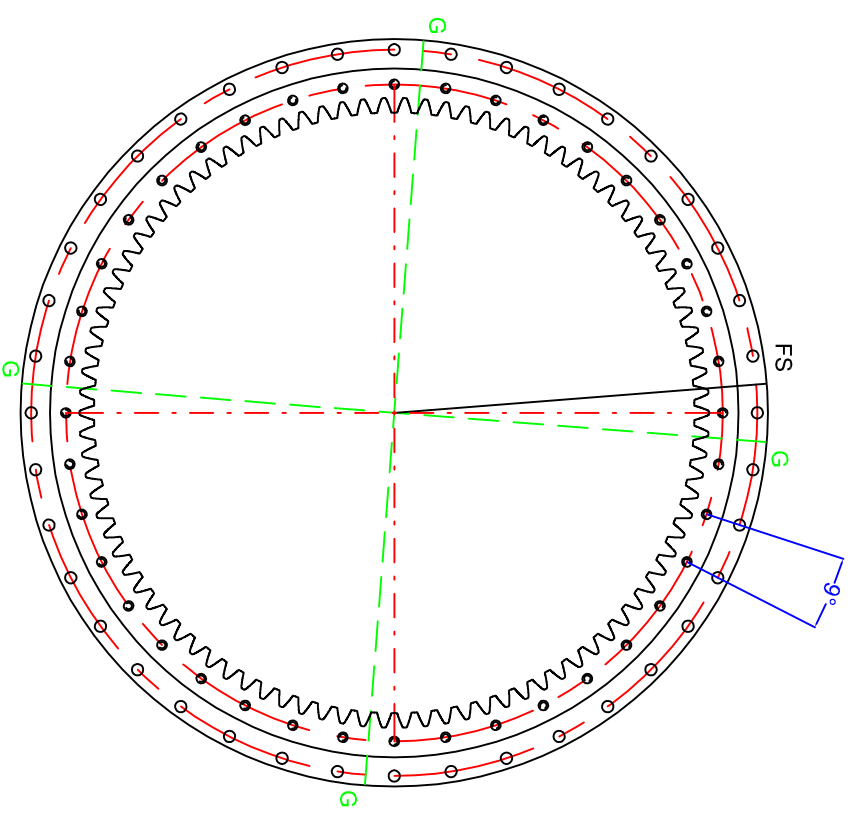

REV	DATE	MODIFICATION	REVISED BY
1			

**QCB Bearings** SLEWING RINGS & DRIVES

Orleton Lane, Wellington, Teitford, TF1 2BG, UK  
 Imported by NBC Group Ltd  
 P: 01962 222300 F: 01962 242938  
 www.nbcgroup.co.uk

QCB® is a registered trademark of NBC Group Ltd

**SIG 916 X14 01 AA LM**

DATE: 05/01/2016  
 DRAWN: LW  
 CHECKED: LLM

QCB RS 11/2016