

GEN. TOLERANCES	0.5 - 6	±0.1	6 - 30	±0.2	30 - 120	±0.3	120 - 315	±0.5	315 - 1000	±0.8	1000 - 2000	±1.2	2000 - 4000	±2	4000 - 8000	±3
GEN. MACHINING		0.4		1.6		3.2			12.6		25 ROUGH					

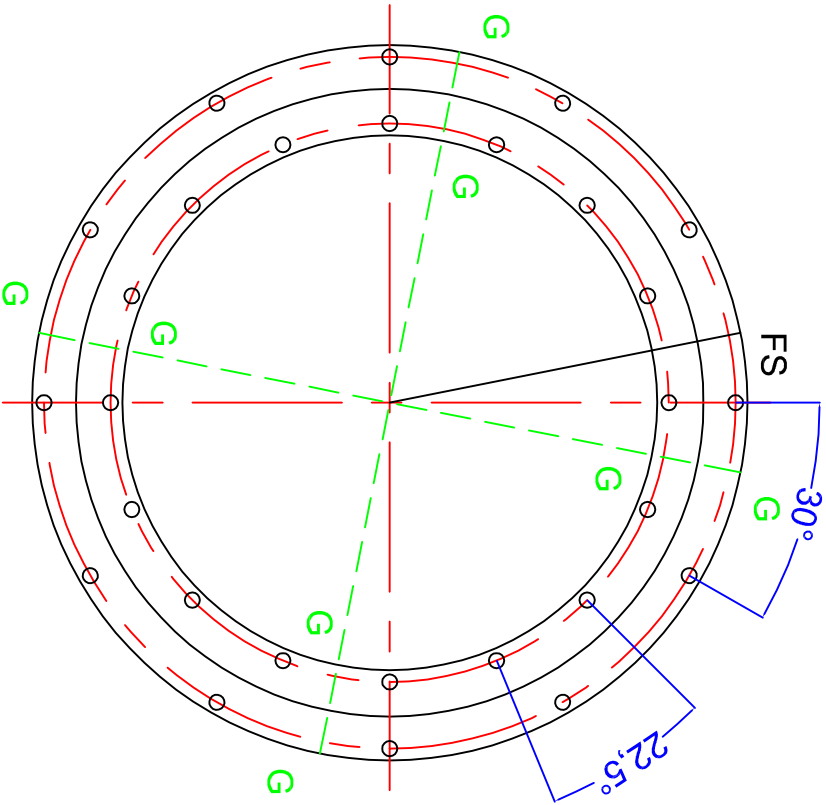
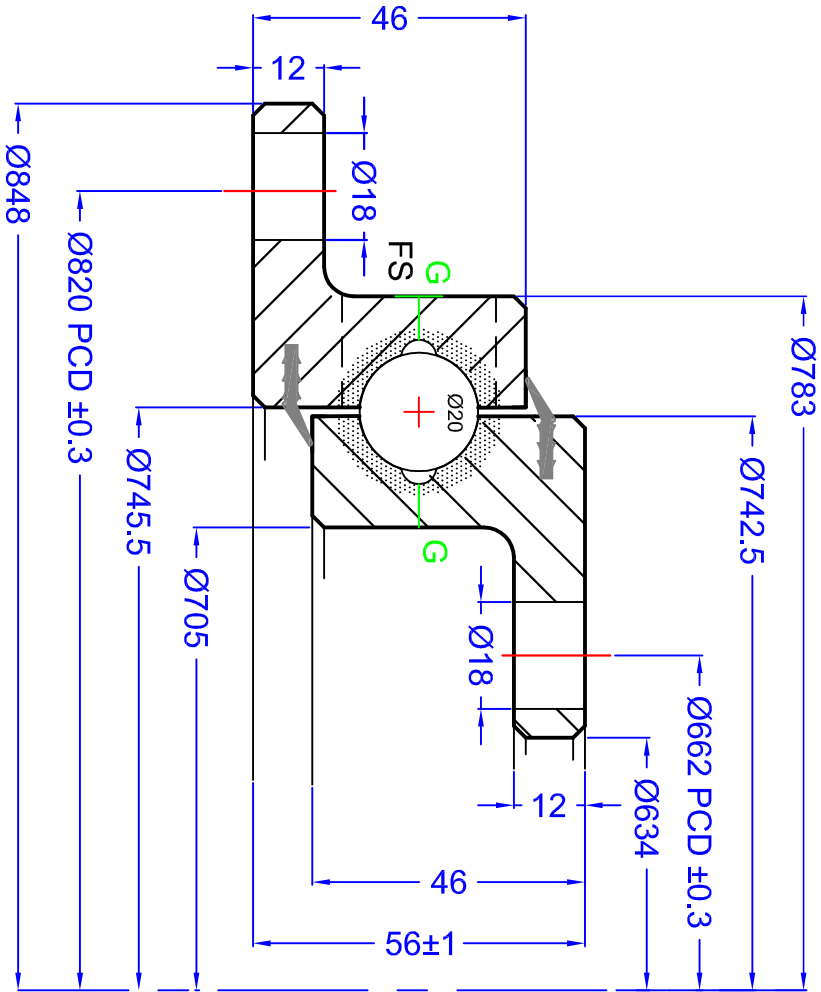
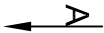

VIEW ON 'A' SHOWING DRILLING PATTERN AND OTHER DETAILS

GEAR DATA		Designed in accordance with designated QCB SLEWING RING STANDARDS													
HARDENED GEAR		Non tolerated dimensions to ISO 2768-1 m													
NUMBER OF TEETH (Z)		All burrs and sharp edges to be removed; Standard corner chamfer 1mm x 45°													
PRESSURE ANGLE (α)		Internal radial and axial clearance figures to QCB standard 2014 or revisions thereof													
ADDENDUM COEFFICIENT (x)		The HARDNESS GAP is to be indicated by stamped letter R or a PAINT mark on the exterior surface													
PROFILE CORRECTION (mm)		The high point of gear eccentricity to be indicated by GREEN or BLUE paint on 3 teeth													
CALCULATED GEAR STRENGTH															
TRUNCATION (mm)		Fz (Normal)		INNER	16 =	MOUNTING HOLES	Ø 18	TURNING TORQUE		AXIAL PLAY	0.12-0.28 mm				
PITCH CIRCLE DIAMETER		Fz (Max)		OUTER	12 =	MOUNTING HOLES	Ø 18	MATERIAL		RADIAL PLAY	0.12-0.28 mm				
MEASUREMENT ON K TEETH		Pin Diameter		GREASE HOLES	G'	4 + 4 M8	WEIGHT								
RUNOUT NOT HARDENED/HARDENED				LOADING PLUG	'FS'	SOFT ZONE	'R'								
© NBC GROUP LTD. NOT BE COPIED WITHOUT PERMISSION				SEAL SIZE		TBA									

REV	DATE	MODIFICATION	REVISED BY
1			

**QCB**  
Bearings

SLEWING  
RINGS &  
DRIVES

Orleton Lane, Wellington, Telford, TF1 2BG, UK  
P: 01952 222300 F: 01952 242938  
www.nbcbgroup.co.uk

QCB® is a registered trademark of NBC Group Ltd

**FUN 850 20 00 CC LM**

OCB RS 11/2016

DRAWN:

DATE:

CHECKED:

LJM

13/05/2015

LJM